

N^o 1

contains a Plan with the measures
of all the Squares, Streets, Lanes, and
Alleys between Cedar & Pine Streets
and from
Delaware to Schrybker

$\left. \begin{array}{r} 109 \\ 220 \\ \hline 3960 \\ 396 \\ \hline 43500 \end{array} \right\} \text{ Lukens's Scale for drawing the}$
 Plans of the Lots Sold by Council, }
 is exactly $\frac{1}{5}$ th of an Inch to 10 feet
 Square feet in One Acre; by Mr Lukens's
 Calculation.

5280 feet in length is one Mile!

69 Mile & a half in length is one Degree

320 Perches = to a mile
 one mile square is 640 Acres

60 ft from South side of Perches will
 come to line of Cedar streets

Aug 15 1786

Free Library
 24675

Amesbury

And the Scale Used in this Book is one 10
 of an Inch to ten feet (Exactly half the size
 of Lukens's.) — And the Scale for drawing
 the Books of Records, is $\frac{1}{3}$ of an Inch to
 10 feet.

The following Plans were drawn 1786

1. 6 ft from South side of Perches will
 come to line of Cedar streets
 2. 6 ft from South side of Perches will
 come to line of Cedar streets
 3. 6 ft from South side of Perches will
 come to line of Cedar streets
 4. 6 ft from South side of Perches will
 come to line of Cedar streets
 5. 6 ft from South side of Perches will
 come to line of Cedar streets
 6. 6 ft from South side of Perches will
 come to line of Cedar streets
 7. 6 ft from South side of Perches will
 come to line of Cedar streets
 8. 6 ft from South side of Perches will
 come to line of Cedar streets
 9. 6 ft from South side of Perches will
 come to line of Cedar streets
 10. 6 ft from South side of Perches will
 come to line of Cedar streets

3/4 into Hunt Street
Cedar-Street

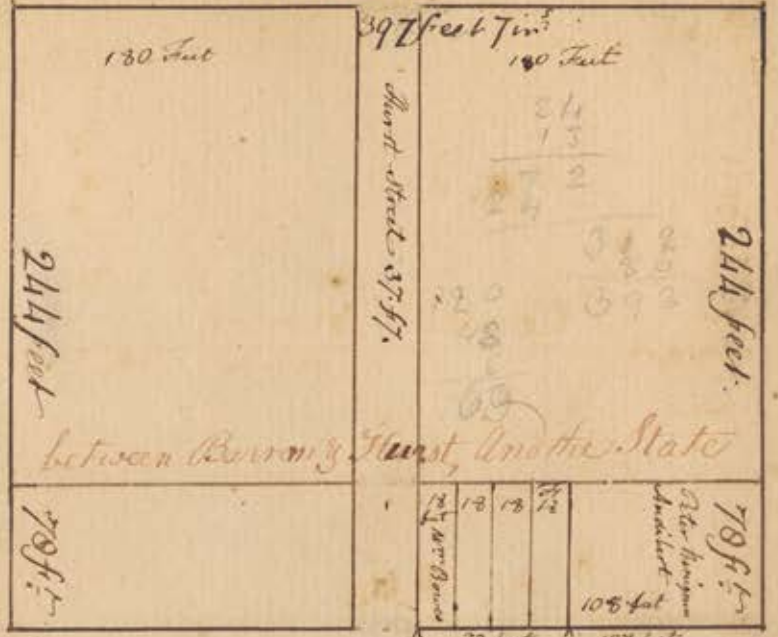

Sixth-Street

Lombard-Street

20	23	24	24	24	24	24	24	24	24	24	24	24	24	24	24	24	24	23	20
147	148	149	150	151	152	153	154	155	156	157	158	159	160	161	162	163	164	165	166
107	108	109	110	111	112	113	114	115	116	117	118	119	120	121	122	123	124	125	126
20	23	24	24	24	24	24	24	24	24	24	24	24	24	24	24	24	24	23	20

Pine-Street

Fifth-Street (From Lukens' Plan N. 2)

Cedar Street



Casskill Street

Fifth Street

Lombard Street

20	24	24	24	24	24	24	24	24	24	24	24	24	24	24	24	24	24	24	20
151	152	153	154	155	156	157	158	159	160	161	162	163	164	165	166	167	168	169	170
107	108	109	110	111	112	113	114	115	116	117	118	119	120	121	122	123	124	125	126
20	24	24	24	24	24	24	24	24	24	24	24	24	24	24	24	24	24	24	20

Pine Street (From Lukens' Plan N. 26)

Fourth Street

Lukens' Plan N. 26

Cedar Street
396 feet

P65

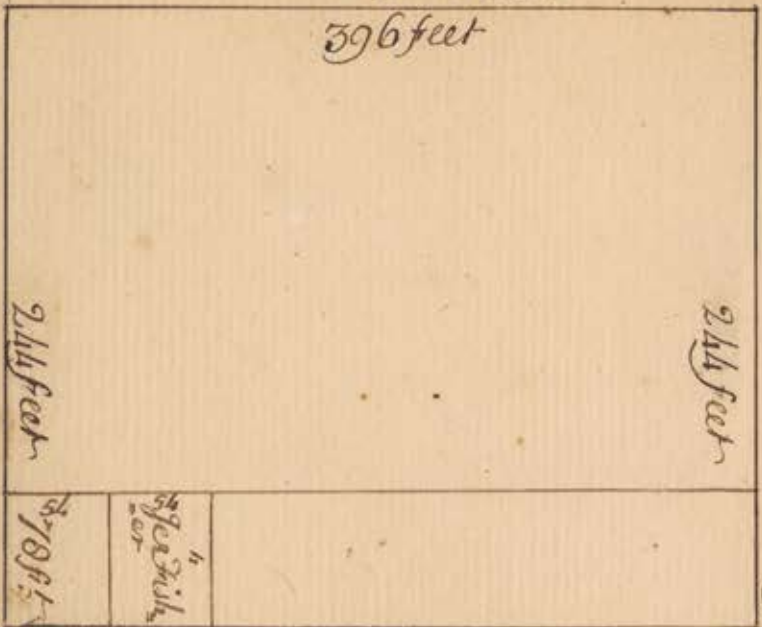

Lombard Street

9th Street

50f

188f	No. 429	No. 419	188f	28
	428	418		28
	427	417		28
	426	416		28
	425	415		29
	424	414		29
	423	413		28
	422	412		28
	421	411		28
188f	No. 420	No. 410	188f	28

{ Birch Lane }
Alley of 20 feet

282f

8th Street

50f

282f

{ From Lukens } Pine Street
Plan No. 6

Cedar Street
396 feet

P73

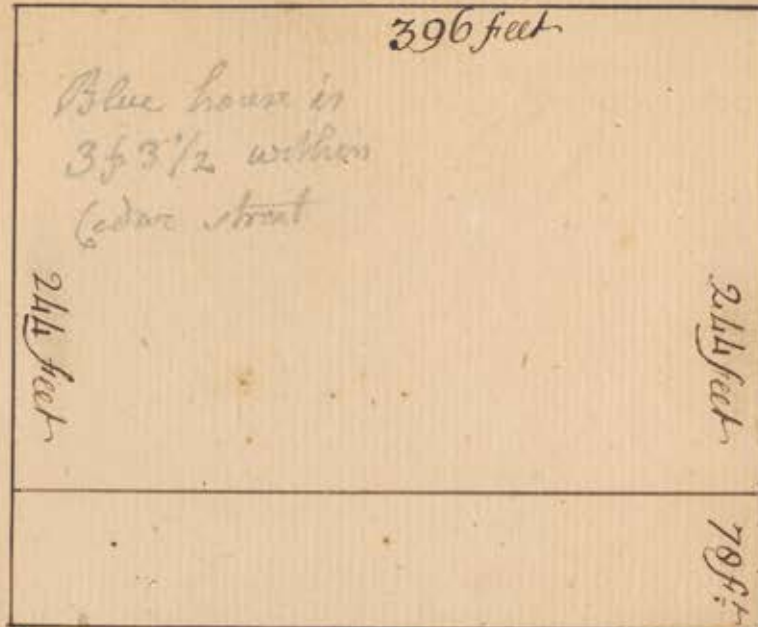

Lombard Street

10th Street

50f

66f	66	66	66	66	66f
					No. 1618
					282 feet
					No. 1619
					1619
					1620
					1621
					1622
					No. 1623
					289 feet
					No. 1623
					66f

{ From Lukens }
Plan No. 23

Pine Street

50f

9th Street

Cedar Street
396 feet

181

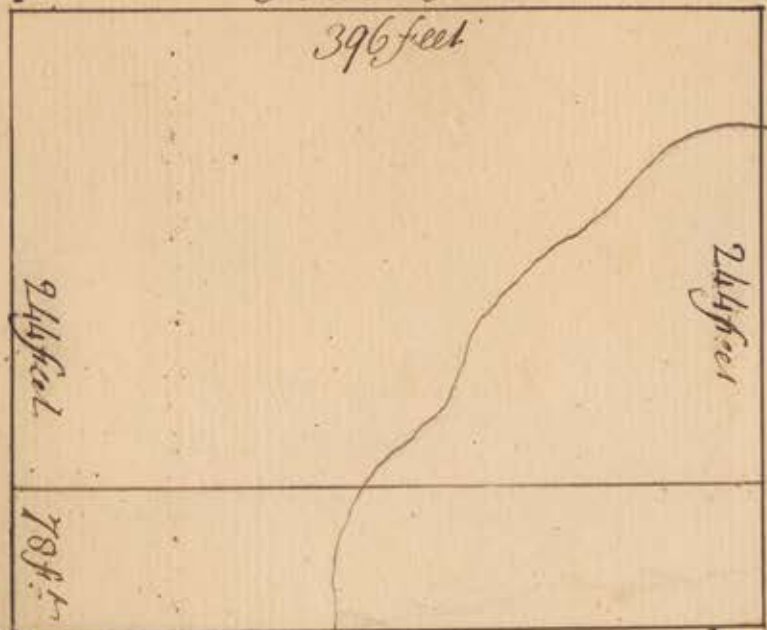

13th Street

Lombard Street

50f

20	23	23	24	24	24	24	24	24	24	24	24	24	23	23	20
141f															
No 689															
688															
687															
686															
685															
684															
683															
682															
681															
680															
679															
678															
677															
676															
675															
674															
673															
672															
20	23	23	24	24	24	24	24	24	24	24	24	24	23	23	20
141f															
No 686															
687															
688															
689															
690															
691															
692															
693															
694															
695															
696															
697															
698															
699															
700															

Pine Street

10th Street
141f
From Lukens' Plan No. 99

Cedar Street
396 feet

189



11th Street

Lombard Street

50f

28	28	28	28	28	28	28	28	28	28	28	28	28	28	28	28
141f															
188f No 919								No 929 188f							
918								928							
917								927							
916								926							
915								925							
914								924							
913								923							
912								922							
911								921							
188f No 910								No 920 188f							
910								920							
909								919							
908								918							
907								917							
906								916							
905								915							
904								914							
903								913							
902								912							
901								911							
900								910							

Pine Street

12th Street
141f
From Lukens' Plan No. 11

Cedar Street
396 feet

097

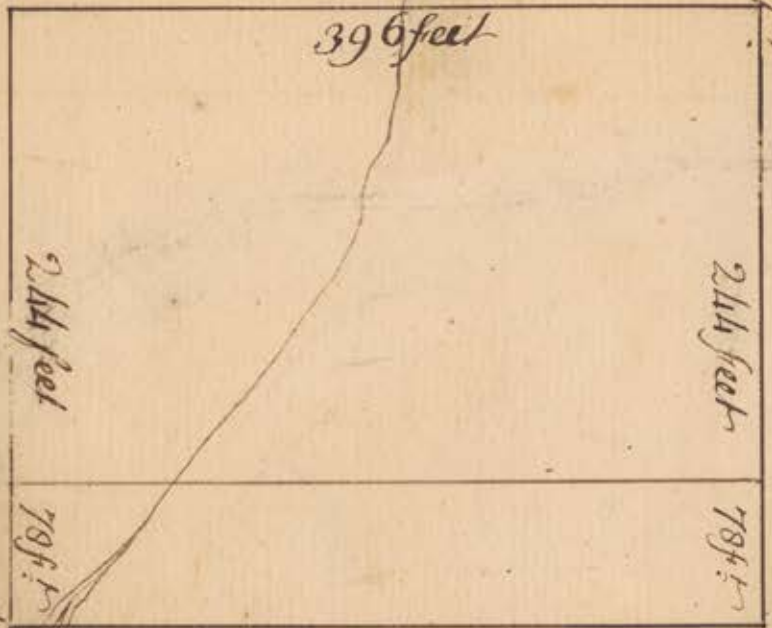

12th Street

Lombard Street

13th Street



Pine Street

{ From Lukens' }
Plan N. 13

Stone 20 f. 578 feet
Cedar Street

0105
51 f

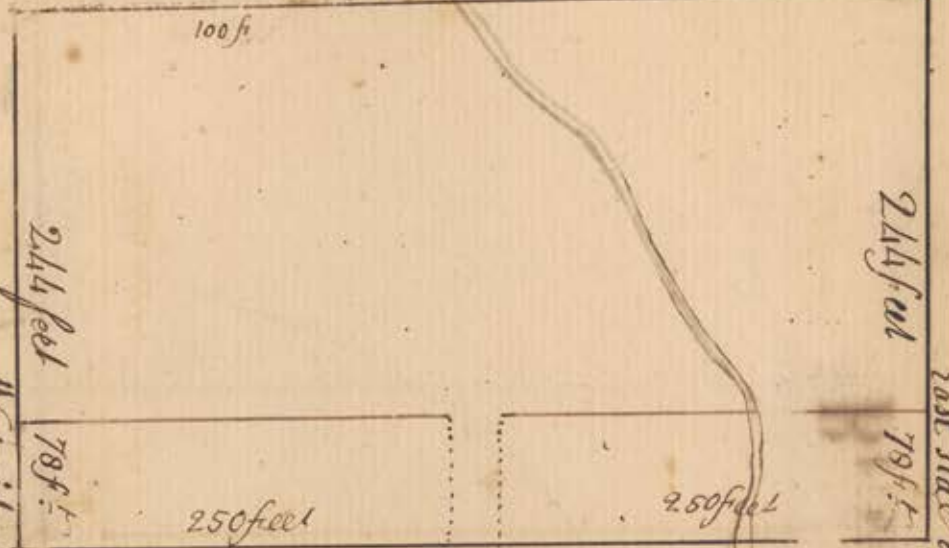

West side of 13th Street 292 f

Lombard Street

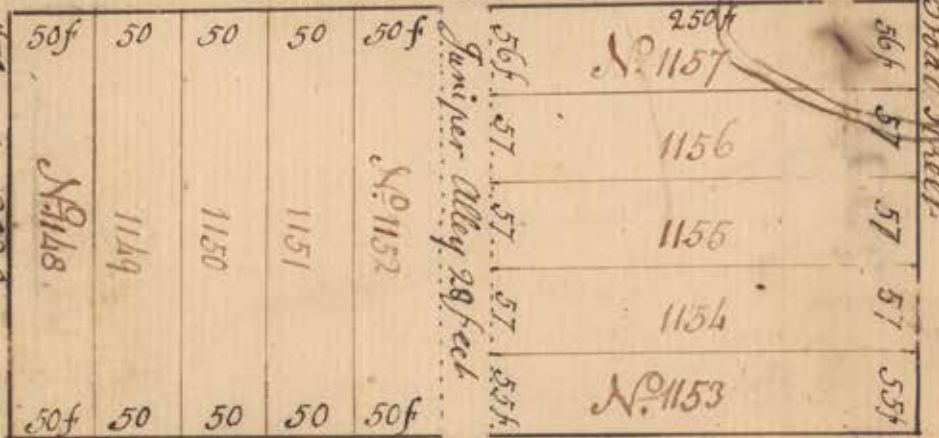

Pine Street

578 feet
From Lukens' Plan N. 14

East side of Broad Street
50 f
56 f
57
57
57
57
55 f
50 f

P121

Cedar Street
396 feet

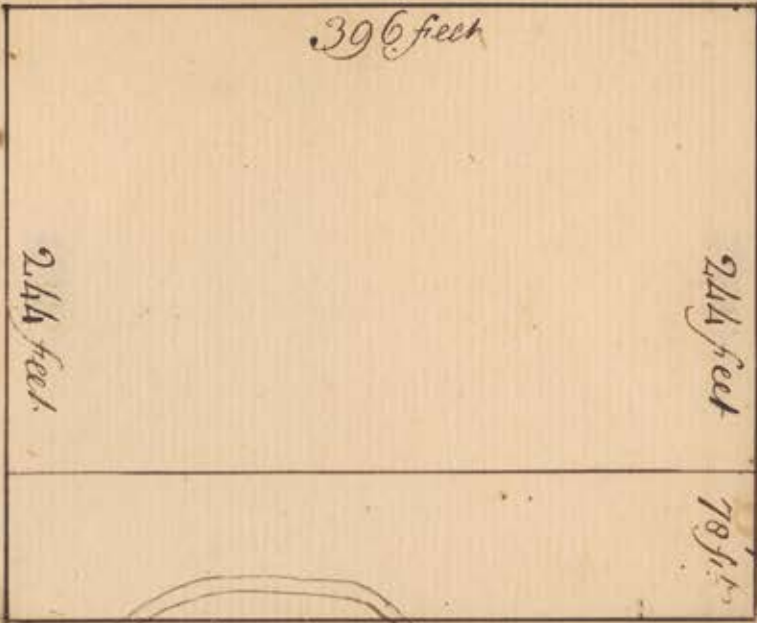

Schuylkill 7th Street } From Jenkins' }
Schuylkill 8th Street } Plan No. 16 }

Lombard Street



Pine Street

P113

Cedar Street
396 feet

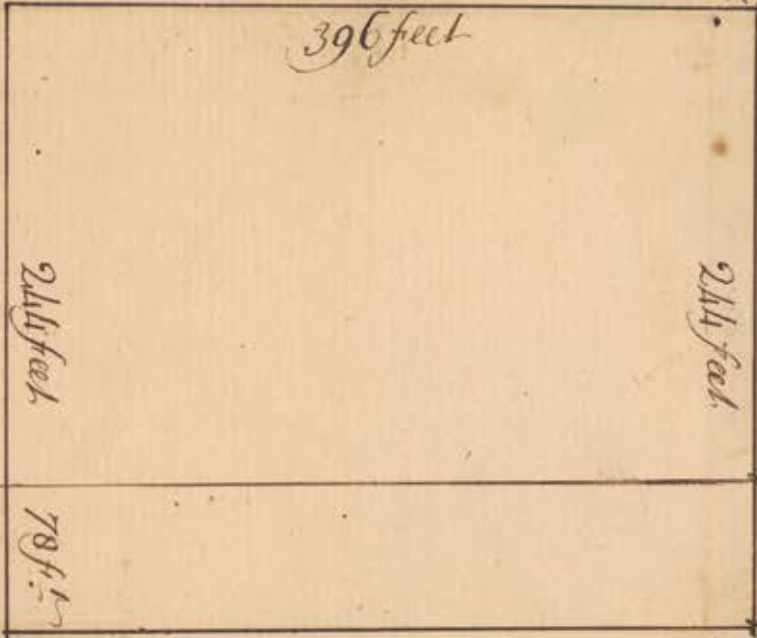

East side of Schuylkill 8th Street

Lombard Street

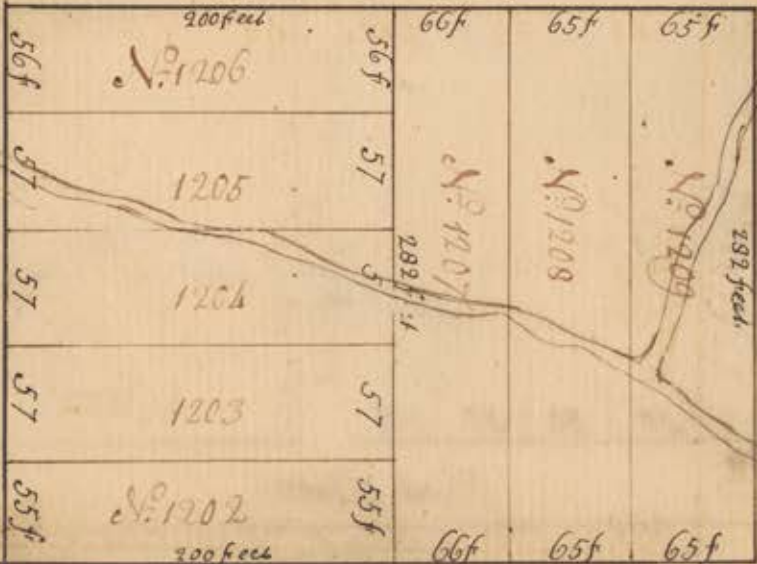

Pine Street

113 feet
A House 10 feet from the
North Line of Cedar Street
Middle of Cedar Street

Broad Street } From Jenkins' }
Plan No. 15 }

Cedar Street

396 feet

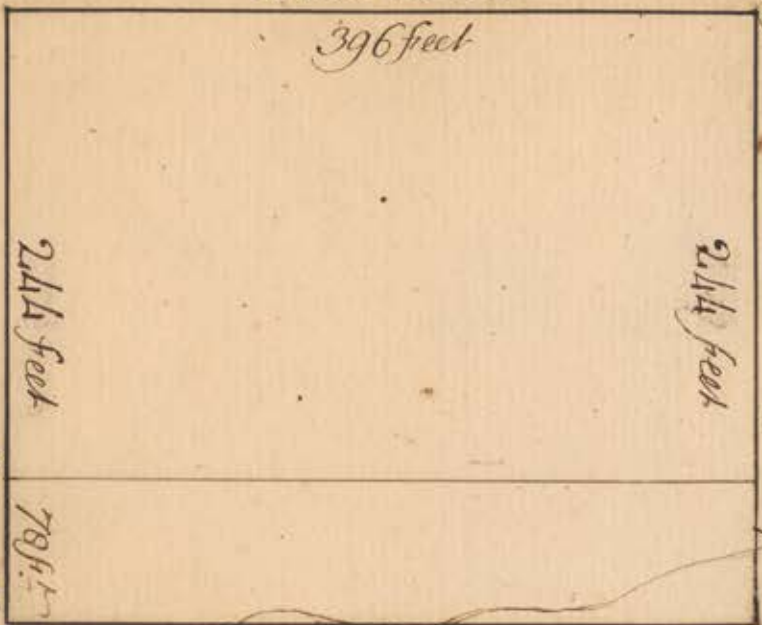

P1929

Schuylkill 6th Street

Lombard Street

50f

66f	66	66	66	66	66f	282 feet	66f
66f	66	66	66	66	66f	N ^o 1368	66f
66f	66	66	66	66	66f	1367	66f
66f	66	66	66	66	66f	1366	66f
66f	66	66	66	66	66f	1365	66f
66f	66	66	66	66	66f	1364	66f
66f	66	66	66	66	66f	1363	66f
66f	66	66	66	66	66f	282 feet	66f

Pine Street

Schuylkill 7th Street } From Lukens' Plan No. 17

Cedar Street

396 feet

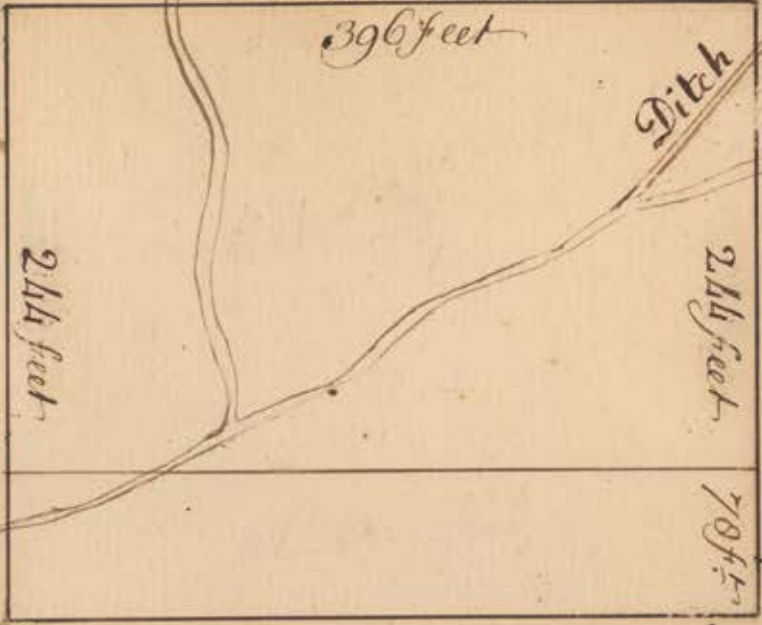

137

Schuylkill 6th Street

Lombard Street

50f

66f	66	66	66	66	66f	282 feet	66f
66f	66	66	66	66	66f	N ^o 1416	66f
66f	66	66	66	66	66f	1415	66f
66f	66	66	66	66	66f	1414	66f
66f	66	66	66	66	66f	1413	66f
66f	66	66	66	66	66f	1412	66f
66f	66	66	66	66	66f	1411	66f
66f	66	66	66	66	66f	282 feet	66f

Pine Street

Schuylkill 5th Street } From Lukens' Plan No. 38

A Stone

Cedar Street

495 feet

0161

244 feet

244 feet

By the Red Line, is meant the Bounds, between

79 ft

50 ft

Lombard Street

50 ft

282 feet

Schuykill 2^d Street

282 feet

495 feet

Pine Street

Schuykill 3^d Street

Cedar Street

396 feet

109

60 feet

244 feet

244 feet

Barren & Heest, And the State.

79 ft

50 ft

Lombard Street

50 ft

282 feet

Schuykill 2^d Street

282 feet

396 feet

Pine Street

60 feet

322 feet

Schuykill front Street

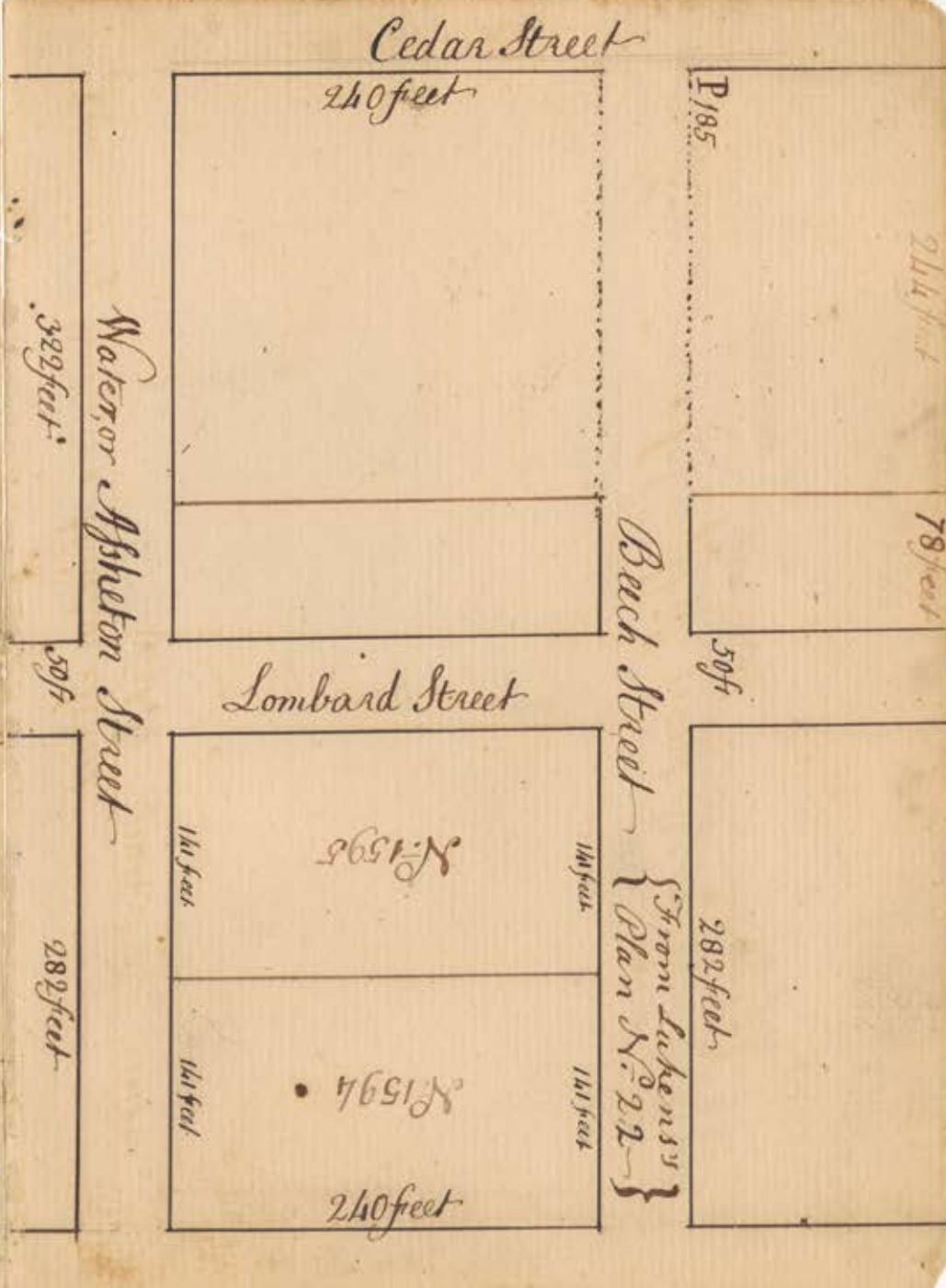
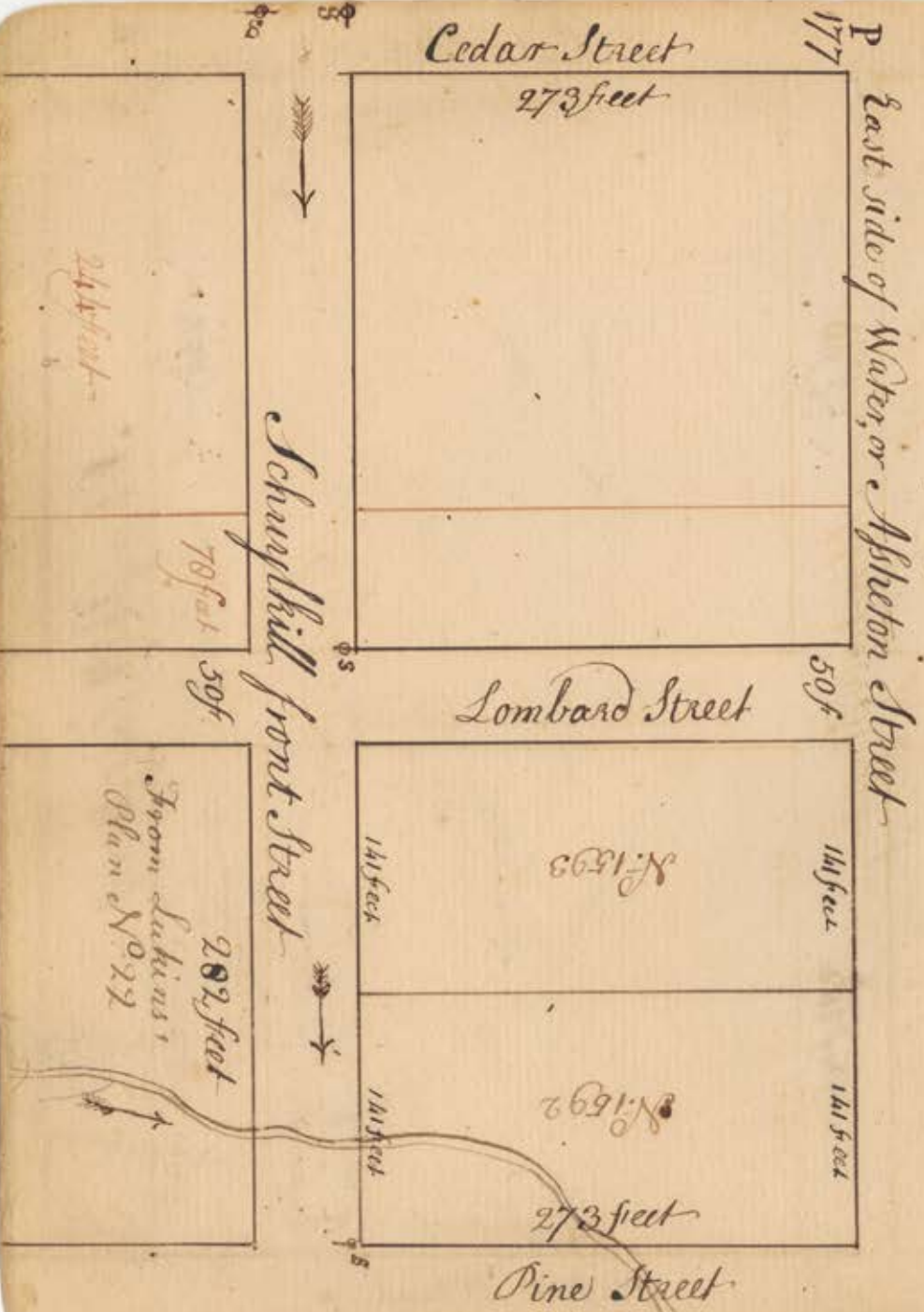

Cedar Street ^{From Willow Street to Schuylkill 820 feet}

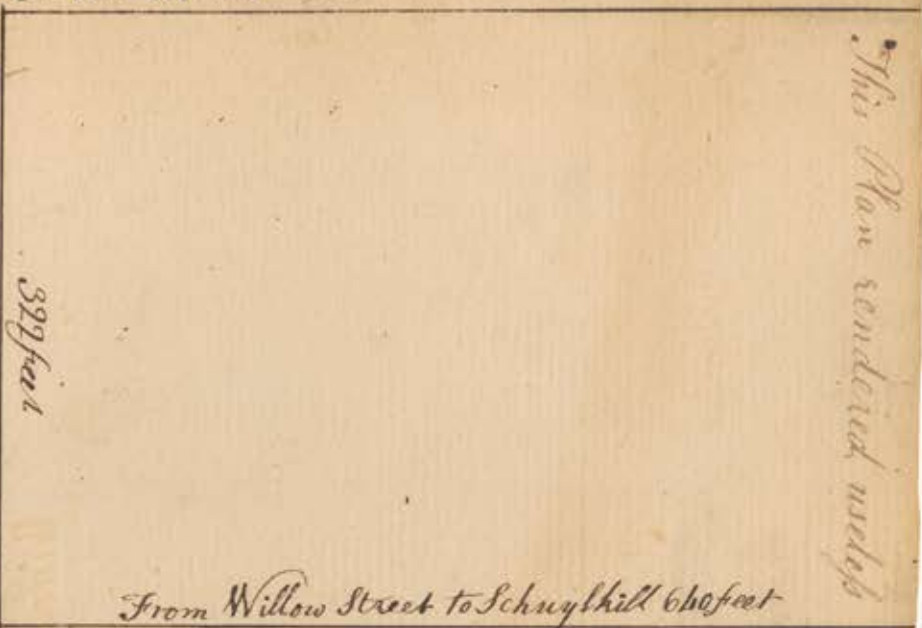

Lombard Street

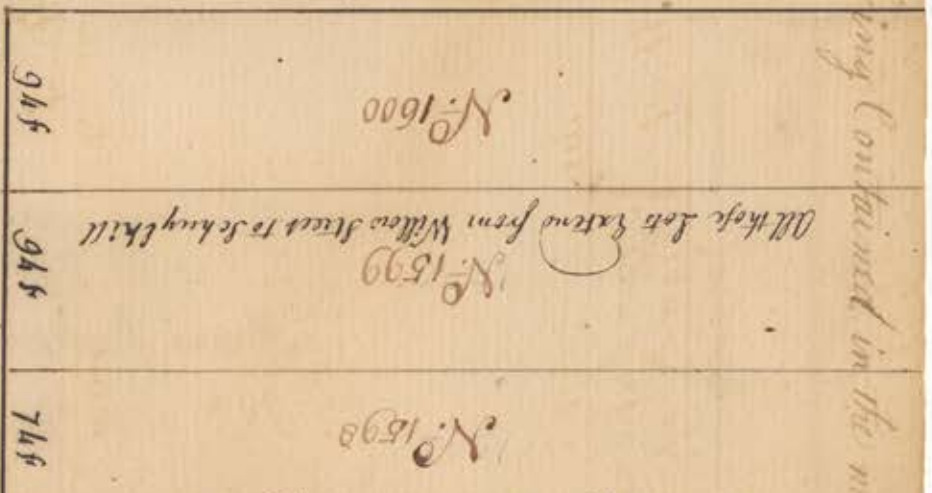

Pine Street

This Plan rendered useless if being contained in the next page

Cedar Street

267 feet

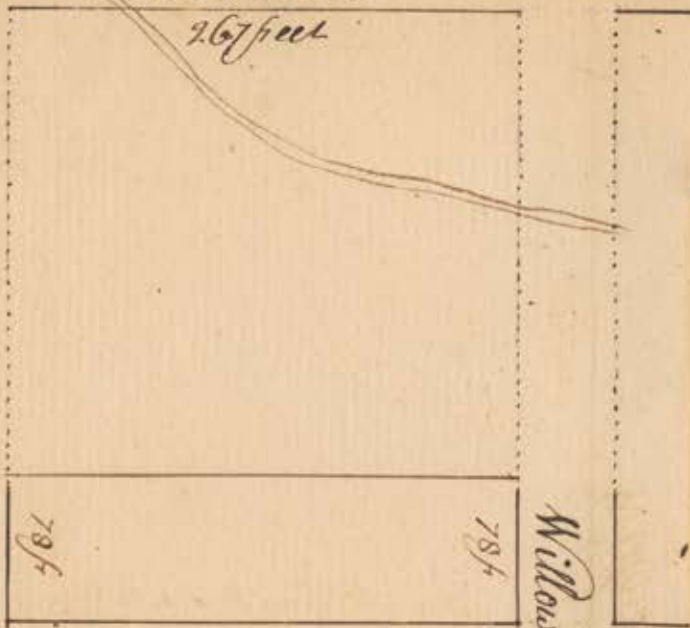

Lombard Street

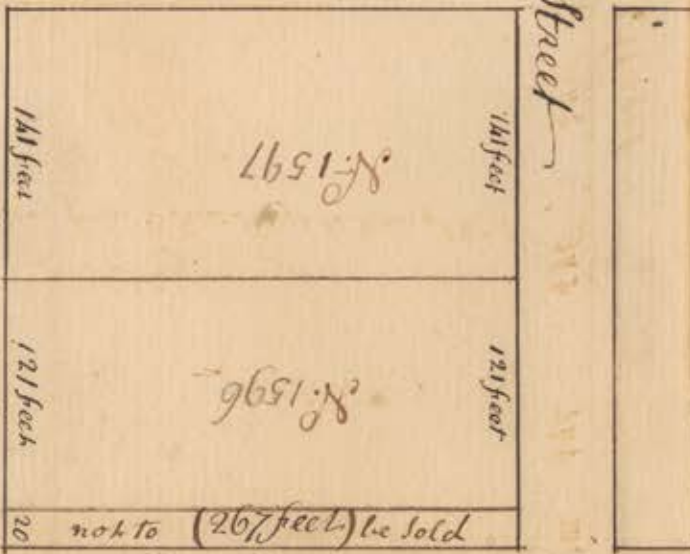

Pine Street

Berch Street

From Jenkins' Plan No. 22

322 feet

289 feet

from Cedar to Pine Street 654 feet

From Willow Street to Schuylkill
North side of Cedar Street

850 feet on the

322 feet

244 feet



244 feet

Barren & Herst comes to the Red Line

796 1/2

From Willow Street to Schuylkill

796 1/2

Lombard Street

735 feet on the North Side by M^r. Lukens

944

2096 N^o

944

6651 N^o

From Lukens's Plan N^o. 22.

744

5091 N^o

From Willow Street to Schuylkill
South Line of Pine Street

563 feet

282 feet

Willow Street

Part of Schuylkill



Barren & Herst

Measures from Delaware to Schuylkill, on Cedar Street		Dist.	
from Delaware to front Street	407	Brought forward 6460.4	
Street	60	Broad Street	1.13
from front to second Street	360	from broad to Schuylkill 8 th Street	396
here the Street is	130	Street	50
To third Street	460	from Schuylkill 8 th to 7 th Street	396
Street	50	Street	50
To fourth Street	395.9	from 7 th to 6 th Street	396
Street	50	Street	50
To fifth Street. (by Measure 40.)	400	from 6 th to 5 th Street	396
Street	50	Street	50
To sixth Street	397.7	from 5 th to 4 th Street	396
Street	50	Street	50
To seventh Street	396	from 4 th to 3 rd Street	396
Street	50	Street	50
To eighth Street	396	from 3 rd to 2 nd Street	495
Street	50	Street	50
To ninth Street	396	from 2 nd to front Street	396
Street	50	Schuylkill front Street	60
To tenth Street	396	50 Oak, or Apheton Street	973
Street	50	Street	50
To eleventh Street	396	from Oak, or Apheton to Beach Street	240
Street	50	Street	50
To twelfth Street	396	from Beach to Willow Street	267
Street	50	Street	50
To thirteenth Street	396	from Willow Street to Schuylkill	850
Street	50	Two mile, one quarter and 150 feet.	12030.4
To broad Street	528		
Carried forward	6460.4		

Measures across the City from South to North

	Cedar Street... 51	
from Cedar to Lombard Street	322	} 654
from Lombard to Pine Street	282	
from Pine to Spruce Street	473	
from Spruce to Locust Street	400	} 820
from Locust to Walnut Street	370	
from Walnut to George Street	235	} 510
from George to Chesnut Street	235	
from Chesnut to high Street	484	
from High to Filbert Street	306	} 664
from Filbert to Mulberry Street	307	
from Mulberry to Cherry Street	288	} 616.5
from Cherry to Sassafras Street	288	
from Sassafras to Vine Street	632.5	
	Vine Street 50	
90 feet 8 inches more than a mile	5370.8	

Joseph _____ 20
 James _____ 20
 65/80

77978446V2E111P12